



€730,000

Ref: PP173276

103 sqm

Residence is a closed condominium that stands out for its functional, modern, bold architecture. Consisting of 33 luxurious apartments on 4 floors, located in the centre of Vilamoura. Construction...

• Pool

• A/C

• Garden

Telephone: +351 213 471 603

Email: info@portugalhomes.com

Praça da Alegria 1, 3rd Floor, 1250-004 Lisboa, Portugal Licence AMI - 14414 | APEMIP 5940

logo not

Property Description

Residence is a closed condominium that stands out for its functional, modern, bold architecture.

Consisting of 33 luxurious apartments on 4 floors, located in the centre of Vilamoura.

Construction began in September 2022 and completion is scheduled for May 2026.

It is a unique place to live or spend holidays and enjoy the tranquillity and lifestyle options that will make your house a unique and pleasant home.

Its architecture stands out for the following characteristics:

Typology T1 to T3;

1st Duplex with double height in the living room;

Spacious apartments

Versatility and use of spaces;

High natural luminosity;

Large balconies or individual terraces;

Private garage for one or two cars with motorised door and storage all in a single basement;

Excellent finishings;

Fully equipped kitchens with Bosch appliances;

Energy efficiency class A or above;

Long swimming pool;

Elegant garden cultivated with plants indigenous to the region;

Equipped gymnasium.

Its excellent location offers quick access to many different amenities

Vilamoura Marina at 500 metres;

Beaches 1 km away;

Health clinic, pharmacy, supermarkets, banks, restaurants and public transport at 200 metres away;

Electric car charging with 20 fast stations 100 metres away

Free public car park at 100 metres.

Mini-golf at 200 metres

Tennis and Padel Academy at 300 metres;

3 Golf Courses within a radius of 2 km;

Vilamoura Riding Centre, 6 km away;

Faro Airport is 24 km away and access to A22 at 10 km

logo

Telephone: +351 213 471 603

Email: info@portugalhomes.com

Praça da Alegria 1, 3rd Floor, 1250-004 Lisboa, Portugal Licence AMI - 14414 | APEMIP 5940

Gallery

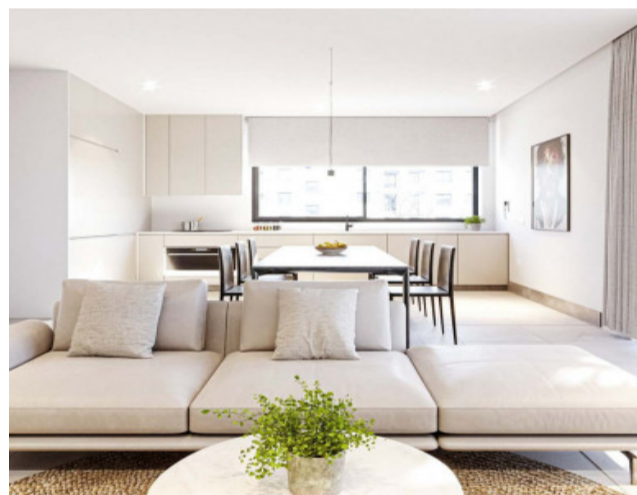
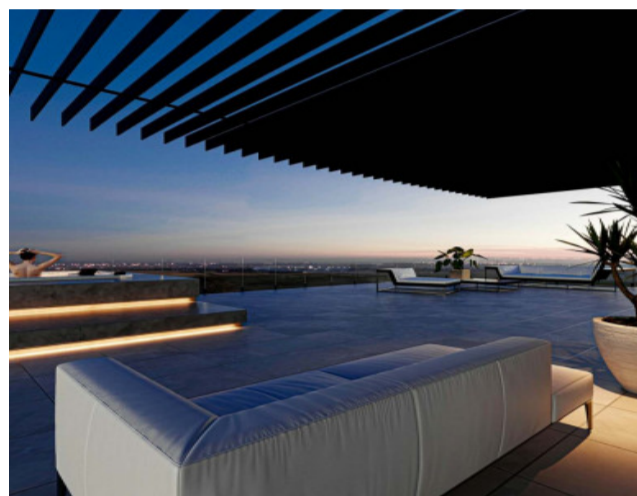

logo

Telephone: +351 213 471 603

Email: info@portugalhomes.com

Praça da Alegria 1, 3rd Floor, 1250-004 Lisboa, Portugal Licence AMI - 14414 | APEMIP 5940

Additional Details

Attributes

Status Available	Net Area 103sq m	Gross Area 103sq m
Year Built 2026		

Property Features

Pool	A/C	Garden
------	-----	--------

logo

Telephone: +351 213 471 603

Email: info@portugalhomes.com

Praça da Alegria 1, 3rd Floor, 1250-004 Lisboa, Portugal Licence AMI - 14414 | APEMIP 5940

Site Floorplan

Telephone: +351 213 471 603

Email: info@portugalhomes.com

Praça da Alegria 1, 3rd Floor, 1250-004 Lisboa, Portugal Licence AMI - 14414 | APEMIP 5940

logo